

Quick Start Guide

X-ray and Gamma Radiation Personal Dosimeter

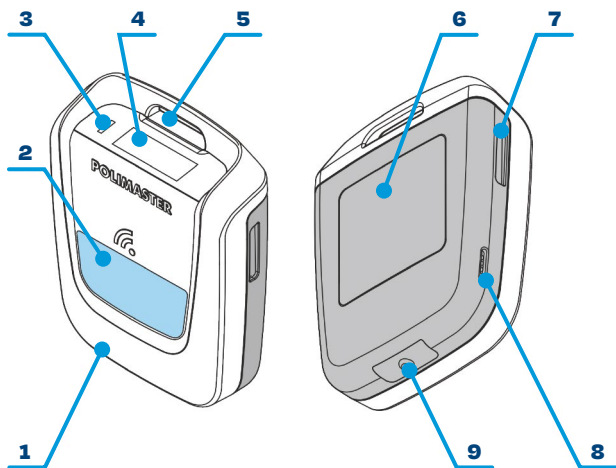

- 1** RadFlash[®] dosimeter
- 2** Place for color sticker
- 3** Visual alarm LED
- 4** LCD screen
- 5** Eyelet for crocodile clip
- 6** Manufacturer label
- 7** Slot for front and back clips
- 8** Audible alarm speakers
- 9** Control button

Getting Started

To charge the dosimeter:

1. Connect the wireless charger to a PC or a power source using the USB cable.
2. Place the dosimeter on the center of the charging pad with the manufacturer label facing down.
3. Charge until the red LED turns off. Before first use, charge the battery for at least four hours.



To switch the dosimeter on:

1. Press and hold the control button until the green LED lights up and the LCD switches on.
2. **Optional:** To enable Bluetooth keep holding the control button until the blue LED lights up and the Bluetooth icon appears.

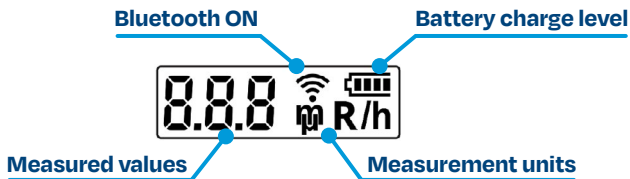

To switch the dosimeter off, hold the control button until the red LED lights up and the LCD switches off.

Avoid full battery discharge as it will reset the dosimeter date and time settings.

Modes and Alarms

The dosimeter operates in two basic display modes: **Dose rate mode** and **Dose mode**. To switch between modes, press the control button.

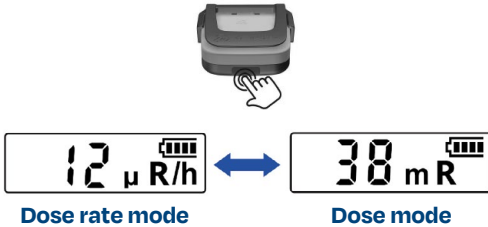

At normal radiation background, the dose rate value should be between 5 μ R/h and 20 μ R/h.

Alarms

The dosimeter has two independent dose rate thresholds and two independent dose thresholds. With two thresholds, you can use the first as a WARNING indicator, and the second as a DANGER indicator.



To mute alarms that have been triggered, press the control button. The alarms are automatically unmuted if the radiation level drops below the thresholds or if new higher thresholds are set.

The dosimeter saves alarm events to its measurement history. To view the dosimeter history, connect the dosimeter to a mobile device or a PC.

Settings

The dosimeter settings can be changed via Bluetooth with a mobile device using the free **Polismart® app** or with a PC using the optional **PM530 Desktop Reader Software** available for purchase from Polimaster.

To install and use the Polismart app, please follow the instructions in the RadFlash Operation Manual.



To connect the dosimeter to a PC using the PM530 Desktop Reader Software, follow the instructions in the User Guide supplied with the software.

Support

Polimaster is pleased to provide free technical support for any questions you may have about installation, setup, troubleshooting, product recommendations or concerns. Please contact your local Polimaster representative or fill in the contact form for technical support at <https://polimaster.com/us/support/>